

January 25, 2023

Request for Quote

Habitat for Humanity of Tuscaloosa is currently accepting bids for contract work on the next round of Habitat homes which will be built in the West End area of Tuscaloosa over the next 6 months. Although all house plans have not yet been selected, we are requesting that you submit your bid based on our typical floor plan, which is attached. Most of our homes will be similar to this plan; 3 bedroom, 2 bath, 1196 square feet, with 9 plumbing fixtures. Contracts will be awarded on a per house basis. These homes will be built, in part, using HOME funds, from the Federal Government. As such, all Federal rules and requirements regarding the use of these funds must be followed by all contractors, sub-contractors, and their employees, including Federal Wage requirements.

Mechanical bids should be as specific as possible regarding equipment, duct sizing, trunk line construction, etc. Bid should be based on 15 seer heat pump with electric air handler in semi-conditioned attic. Roof deck will be spray-foamed, so ductwork can be R-6. Some means of fresh air intake must also be provided (either through an ERV or fresh air intake on the outside unit). Mechanical contractors must meet current Energy Code, as required by City of Tuscaloosa. Installation of dryer vent, 2 bath fan vents and a kitchen fan (instead of a ducted vent hood) should be included.

Electrical bids should be based on a per square foot price and include general wire sizing, branch panel, outside service panel, 2 exterior GFI's, 4 flood lights, wiring for lighting, receptacles and fire alarms, phone and cable in bedrooms and living room, ac and auxiliary equipment, and installation of all electrical fixtures. Electrician will also supply and install an intermittent bath fan switch in the guest bathroom. All light fixtures will be provided by Habitat.

Plumbing bids should include a price per fixture with fixtures listed. The bid should also include water and sewer line install bids either per foot or standard rate. Bids should include labor and materials, rough-in, stack-out, and trim-out. Fixtures (sinks, faucets, toilets, tubs) and fixture supplies will be provided, but plumber may be asked to have tubs and toilets picked up or delivered.

All bids require contractors to meet all local codes. It will be the responsibility of the contractor to call in inspections and follow up to pass inspections before payments are approved.

Proposed draw schedules should also be included in each bid. Bids should also express the scope and duration of warranties for materials and labor. Contractors will be given advance notice of prospective schedules and be expected to perform within 3 days of desired start date.

All contractors must follow all applicable federal guidelines, including non-discriminatory practices, federal wage requirements, immigration laws, and work hours and safety regulations. Acting as the agency, we will also follow these standards and will award all contracts based on price and proven service record. All qualified applicants will receive consideration for contract awards without regard to race, color, religion, sex, national origin, age, or handicap.

In addition to the bid, we request proof of insurance (including workman's comp. and liability), applicable contractor's license, and city business license. Prompt service and quality of workmanship are as important to us as price; please provide references of previous customers / job addresses we can visit to verify work quality / customer satisfaction.

All bids should be submitted via e-mail to bids@habitattuscaloosa.org. This is an electronic sealed bid process. All quotes will be opened together after the close of bidding, which will be 8:00 am on Friday, February 17, 2023.

Please contact Brandon Kasteler, Habitat Tuscaloosa Construction Manager, with any questions at brandon@habitattuscaloosa.org

DOOR SCHEDULE

| QTY | SIZE/SWING | TYPE |
|-----|----------------|-----------|
| 1 | 3-0 X 6-8 LH | EXT WOOD |
| 1 | 3-0 X 6-8 LH | EXT METAL |
| 1 | 5-0 X 6-8 TWIN | INT |
| 1 | 4-0 X 6-8 TWIN | INT |
| 3 | 3-0 X 6-8 LH | INT |
| 2 | 3-0 X 6-8 RH | INT |
| 1 | 2-6 X 6-8 RH | INT |
| 1 | 2-0 X 6-8 RH | INT |

WINDOW SCHEDULE

| QTY | SIZE | TYPE |
|-----|--------------|-------|
| 9 | 3-0 X 5-0 SH | VINYL |
| 1 | 3-0 X 3-0 SH | VINYL |

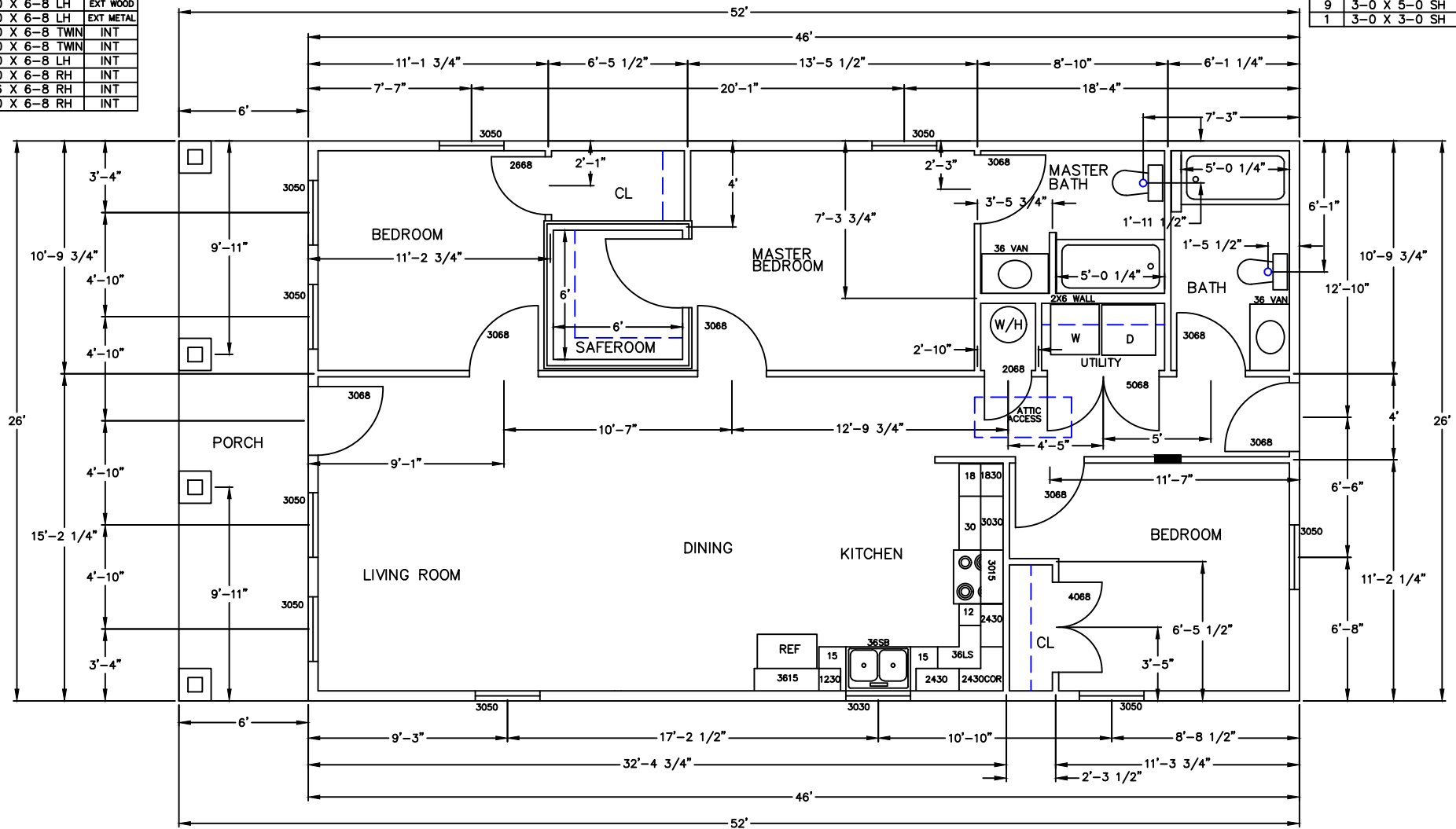

FLOOR PLAN

1196 SQ FT

THE STERLING - DR
3 BEDROOM/2 BATH

HABITAT for HUMANITY
TUSCALOOSA

12/3/21